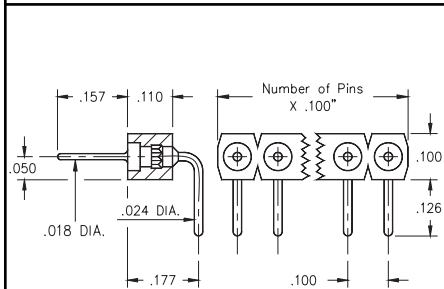

**Fig. 1**

- Series 3XX are available with straight and right angle solder tails.
- Series 350 & 399...009 use MM #3404 and #5011 pins. See pages 170 & 172 for details.
- Series 310 & 399...003 use MM #1001 and #1103 receptacles. See pages 134 & 135 for details.
- Receptacles use Hi-Rel, 4 finger #30 BeCu contact rated at 3 amps. See page 208 for details.
- Insulators are high temp. thermoplastic.



**Ordering Information**



**Fig. 2**

**Series 350...006      Straight Pin Header**

**Fig. 1**

350-XX-1\_\_-00-006000

**Specify # of pins**      **01-64**

**Series 399...009      Right Angle Pin Header**

**Fig. 2**

399-XX-1\_\_-10-009000

**Specify # of pins**      **01-64**

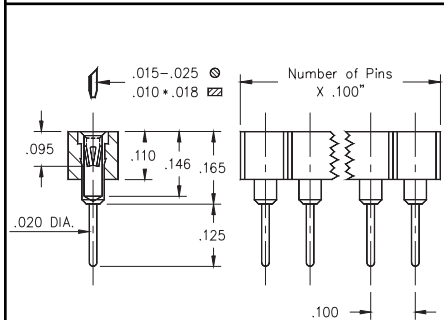

**Fig. 3**



**XX= Plating Code**  
**See Below**

*For RoHS compliance  
select  $\diamond$  plating code.*

SPECIFY PLATING CODE XX=	<b>10</b> $\diamond$	<b>90</b>	<b>40</b> $\diamond$	
Pin Plating	10 $\mu$ " Au	200 $\mu$ " Sn/Pb	200 $\mu$ " Sn	

**Series 310...001      Straight Socket**

**Fig. 3**

310-XX-1\_\_-41-001000

**Specify # of pins**      **01-64**

**Series 399...003      Right Angle Socket**

**Fig. 4**

399-XX-1\_\_-10-003000

**Specify # of pins**      **01-64**



**XX= Plating Code**  
**See Below**

*For RoHS compliance  
select  $\diamond$  plating code.*

SPECIFY PLATING CODE XX=	<b>13</b> $\diamond$	<b>91</b>	<b>93</b>	<b>99</b>	<b>41</b> $\diamond$	<b>43</b> $\diamond$	<b>44</b> $\diamond$
Sleeve (Pin)	10 $\mu$ " Au	200 $\mu$ " Sn/Pb	200 $\mu$ " Sn/Pb	200 $\mu$ " Sn/Pb	200 $\mu$ " Sn	200 $\mu$ " Sn	200 $\mu$ " Sn
Contact (Clip)	30 $\mu$ " Au	10 $\mu$ " Au	30 $\mu$ " Au	200 $\mu$ " Sn/Pb	10 $\mu$ " Au	30 $\mu$ " Au	200 $\mu$ " Sn